

PLANTA 01
Escala 1/10

PLANTA 02
Escala 1/10

PLANTA 03
Escala 1/10

PLANTA 04
Escala 1/10

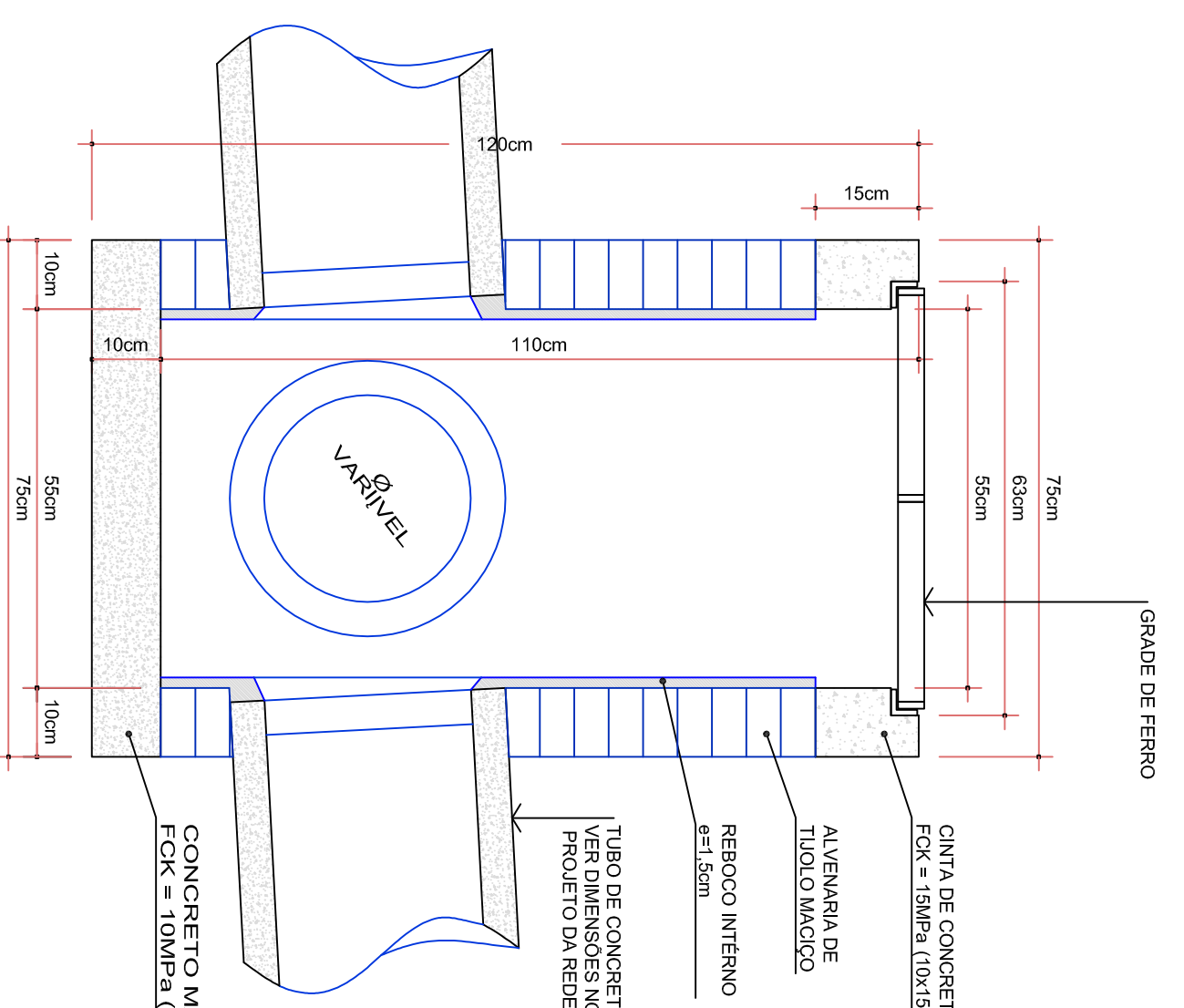
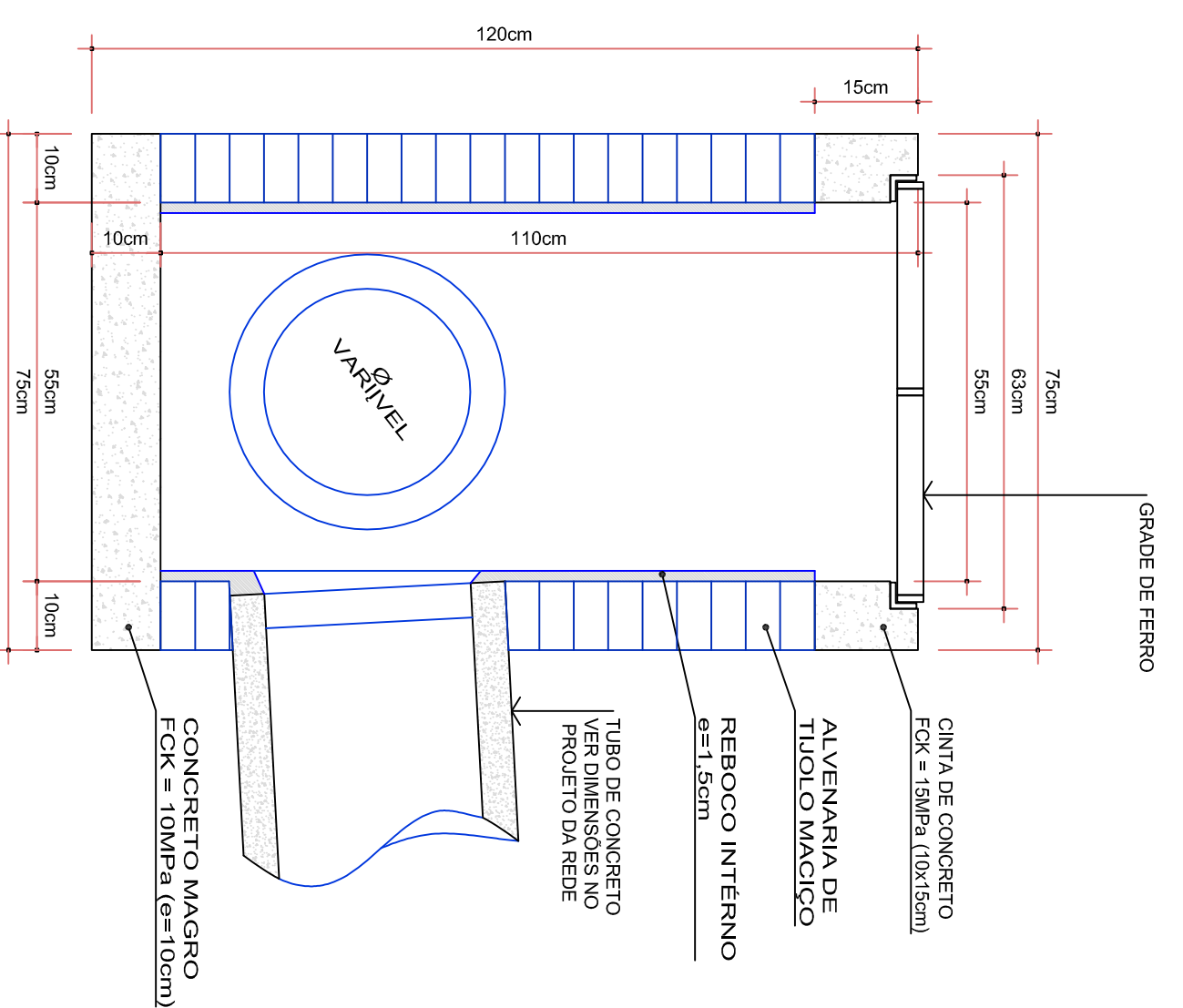
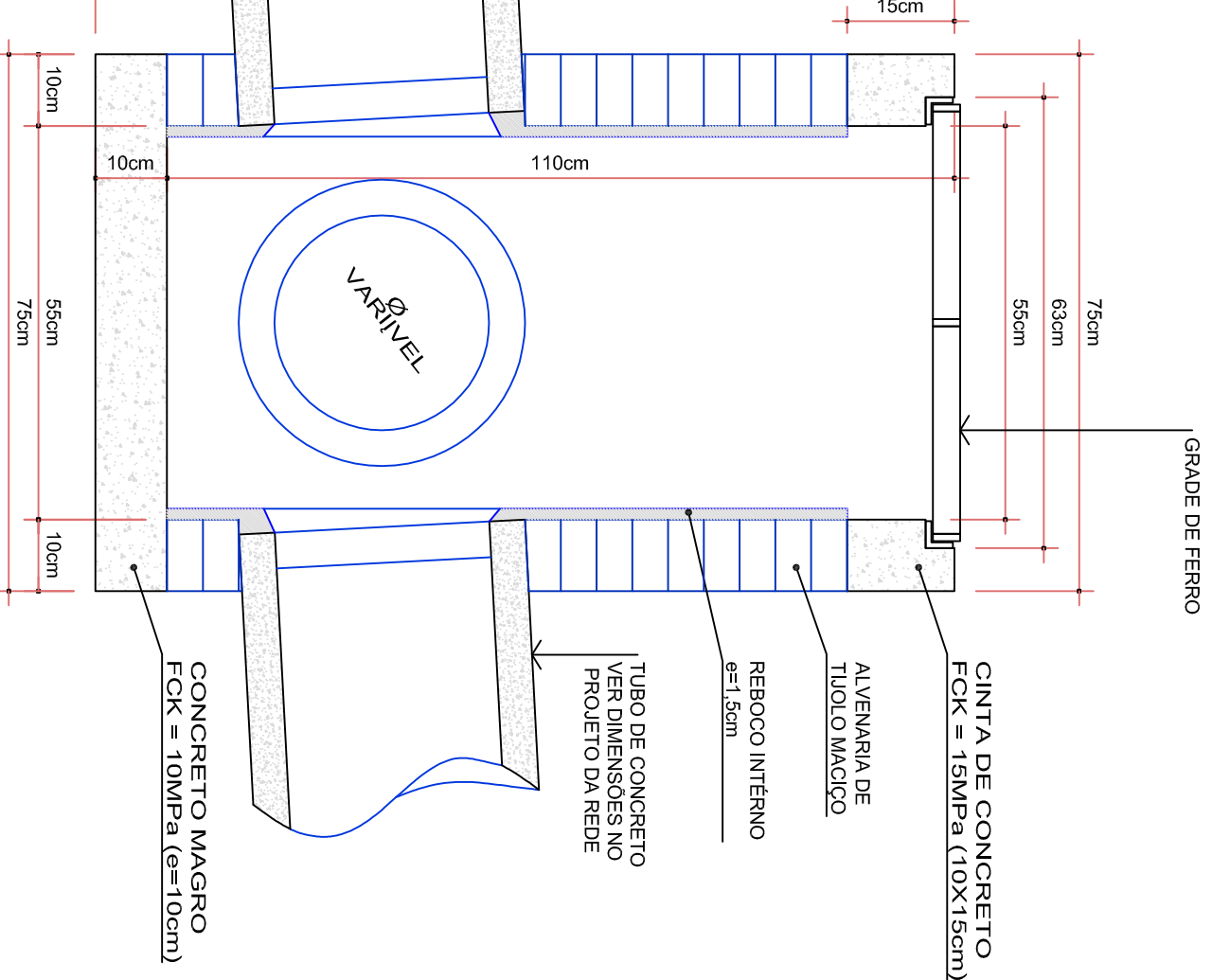
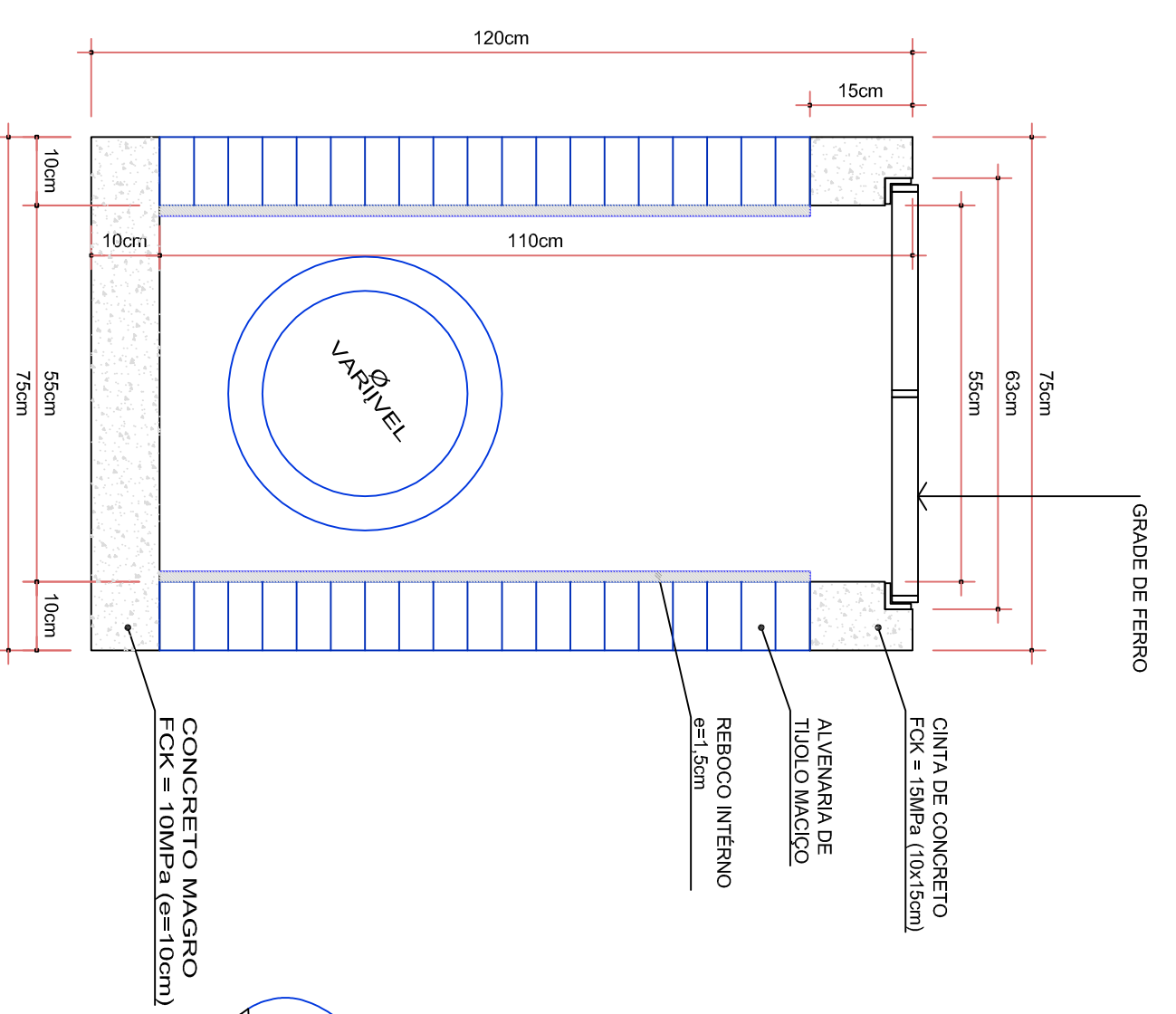

CORTE AA
Escala 1/10

CORTE BB
Escala 1/10

CORTE CC
Escala 1/10

CORTE DD
Escala 1/10

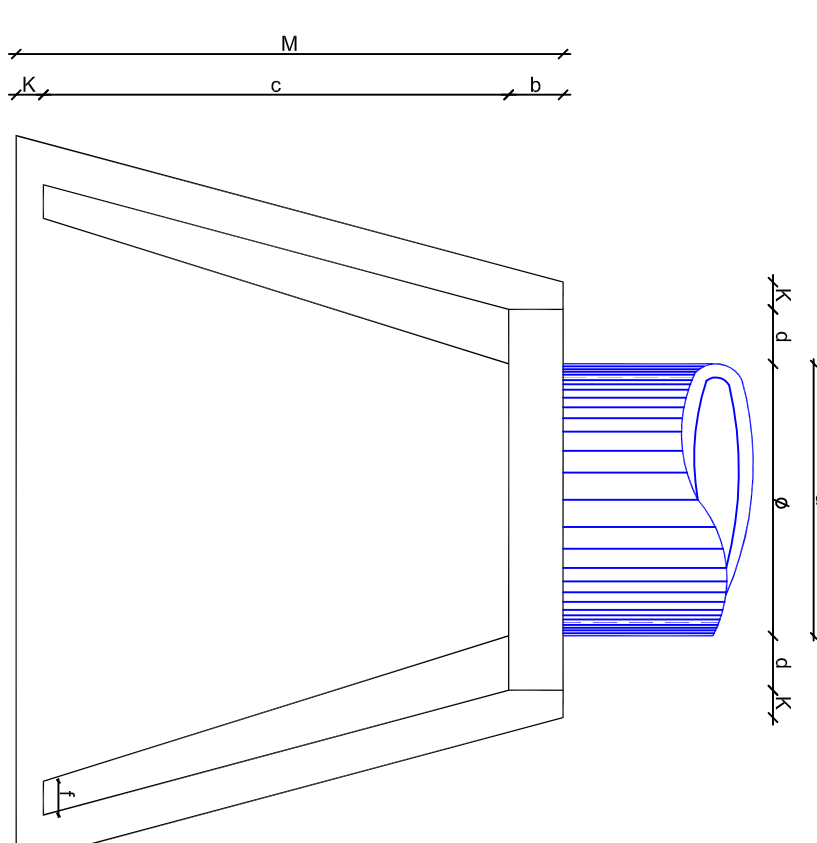
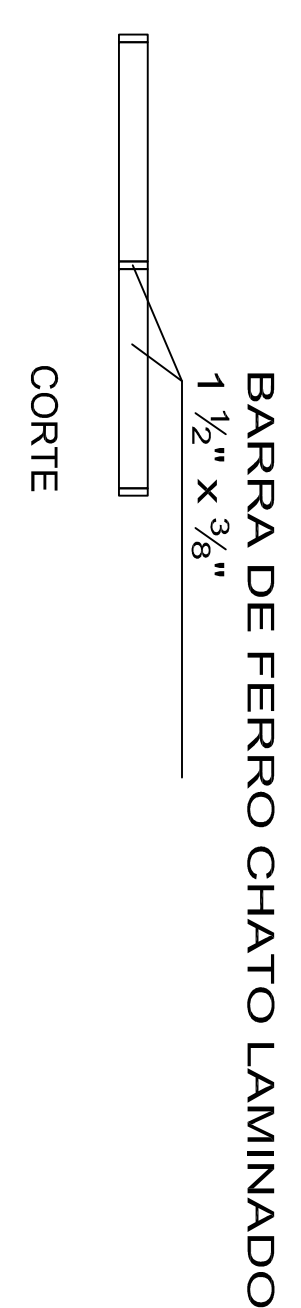
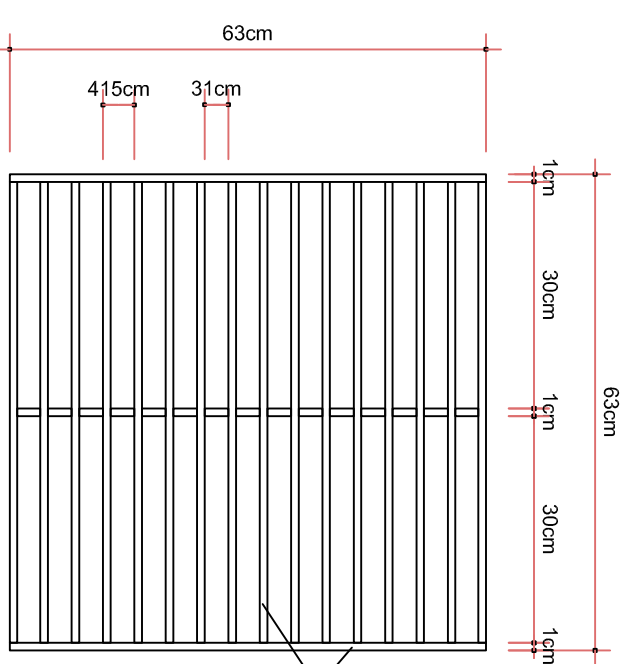
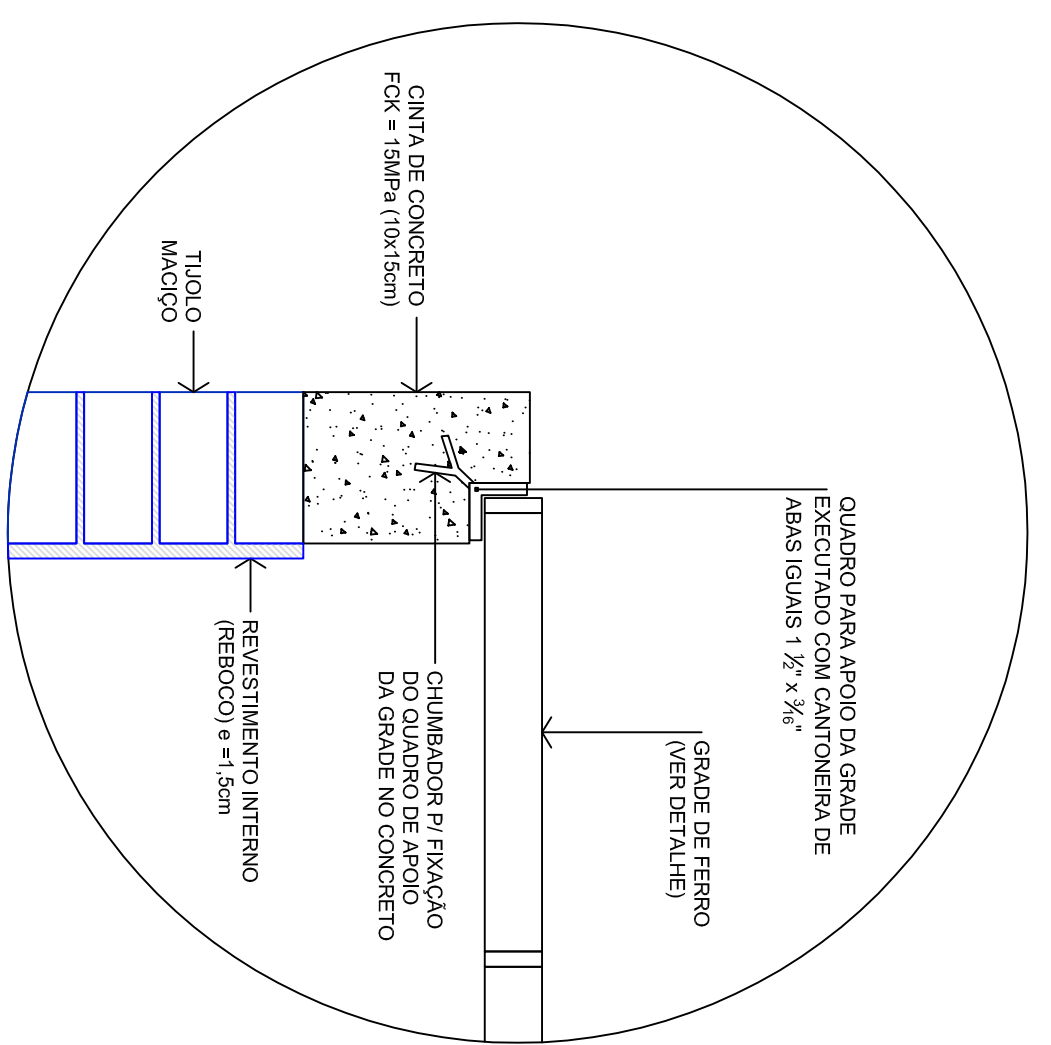

DETALHE APOIO DA GRADE
Escala 1/5

DETALHE DA GRADE
Escala 1/10

VISTA SUPERIOR
Escala Relativa

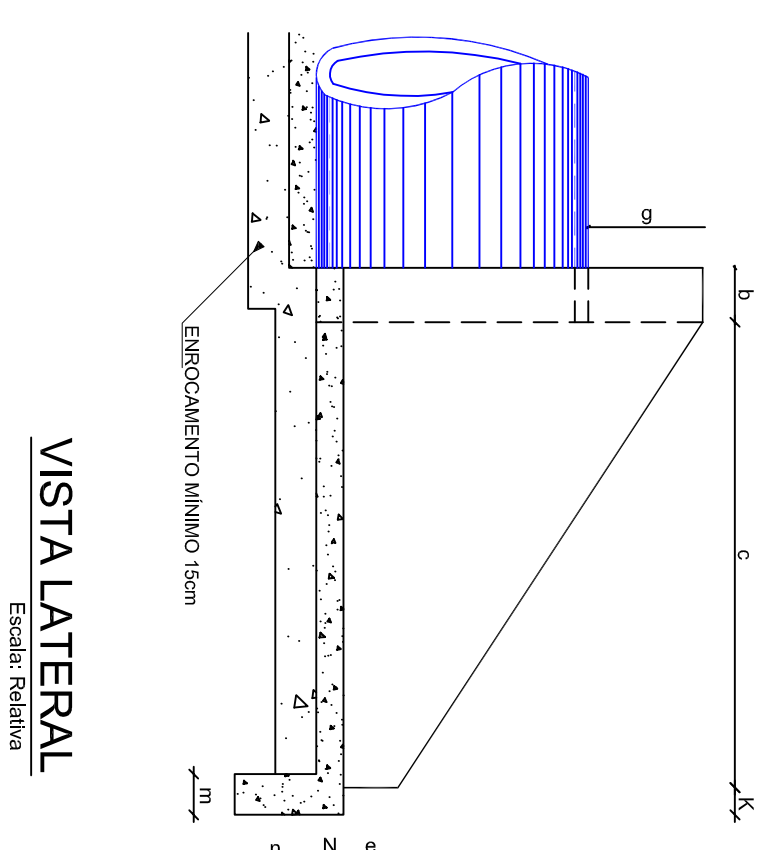

VISTA LATERAL
Escala Relativa

TABELA DE VALORES EM "cm"															CONSULMO DE MATERIAL		
LEGENDA DAS POSIÇÕES															CONCR.	FORMA	EMROC.
B.S.T.C.	a	b	c	d	e	f	g	K	m	n	H	L	M	N	m³	m²	m²
630	45	15	60	15	10	8	20	5	10	20	56	56	80	8	0,124	1,48	0,074
640	55	15	80	15	10	8	20	5	10	20	68	68	100	8	0,178	2,02	0,107
650	65	15	100	15	10	8	20	5	10	20	80	80	110	8	0,241	2,95	0,147
BARRA SER USADO CONCRETO FCK 150kg/cm²															0,559	4,27	0,338
660	100	20	110	20	15	10	20	10	15	30	110	170	170	0	0,813	4,88	0,448
680	120	20	140	20	15	10	20	10	15	30	130	200	200	0	1,225	6,96	0,665
6100	140	20	171	20	15	20	10	15	30	132	220	201	10	1,295	9,52	0,836	
6120	160	20	187	30	25	15	20	10	15	30	163	248	217	10	1,393	14,32	1,325
6150	210	20	230	40	30	20	20	10	15	30	185	300	268	10	2,580	23,64	2,280
6200	280	20	290	40	40	30	20	10	15	30	235	460	320	10	4,884	23,64	2,280

DEVERÁ SER USADO CONCRETO FCK 150kg/cm²

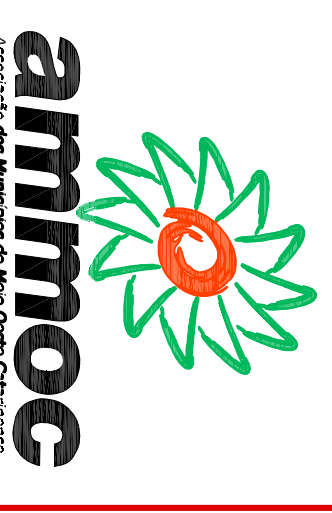

MUNICÍPIO DE HERVAL D'OESTE - SC

PAVIMENTAÇÃO EM PARALELEPÍEDROS E CONCRETO ARMADO
PROJETO DE PAVIMENTAÇÃO
DETALHAMENTO DAS BOCAS-DE-LOBO E GRADES

Arquiteta Responsável Técnico: DENIR NARCIZO ZULIAN - ENGª CIVIL - CREASC 50.805-8
Arquiteta Responsável de um Escopo: DRE. 02/02

Arquiteta Responsável de um Escopo: ANA JULIA UNGERICH - ENGª CIVIL - CREASC 105.295-8
Arquiteta Responsável de um Escopo: LUCAS BALISTRIN - ABRIL / 2014